



Publication Date: November 6, 2006  
Vol. 30, No. 23

Next Publication: November 20, 2006  
Submittal Deadline: November 13, 2006

# EQB MONITOR

## ENVIRONMENTAL ASSESSMENT WORKSHEETS

EAW Comment Deadline: December 6, 2006

### **Project Title: Al-Corn Fuel Facility Expansion**

**Description:** Al-Corn Fuels proposes to expand its existing dry-mill ethanol production facility. The current capacity is 34.9 million gallons per year (MMGY) of 200-proof ethanol with a corn throughput of approximately 13.2 million bushels per year (MMBu/year). The proposed expansion would be to 50 MMGY of 200-proof ethanol with a corn throughput of approximately 18.5 MMBu/year of corn and an increase in water appropriation of 53.4 MMGY.

**RGU:** Minnesota Pollution Control Agency

### **Contact Person:**

Kelly Garvey, Project Manager  
Environmental Review and Operations Section  
Regional Division  
Minnesota Pollution Control Agency  
520 Lafayette Road No.  
St. Paul, MN 55155  
(651) 296-7796

The *EQB Monitor* is a biweekly publication of the Environmental Quality Board that lists descriptions and deadlines for Environmental Assessment Worksheets, Environmental Impact Statements, and other notices. The *EQB Monitor* is posted on the Environmental Quality board home page at <http://www.eqb.state.mn.us/>.

Upon request, the *EQB Monitor* will be made available in an alternative format, such as Braille, large print, or audio tape. For TTY, contact Minnesota Relay Service at 800-627-3529 and ask for Department of Administration. For information on the *EQB Monitor*, contact:

Minnesota Environmental Quality Board  
658 Cedar St., 300 Centennial Office Building  
St. Paul, MN 55155-1388  
Phone: 651-201-2480  
Fax: 651-296-3698  
<http://www.eqb.state.mn.us>

**Project Title: Emerald Heights**

**Description:** Emerald Heights is a 14-lot single-family residential development located on approximately 79.3 acres in Little Sauk Township of Todd County. The project will include infrastructure construction and home construction and will be serviced by individual sewage treatment systems and private wells.

**RGU:** Todd County

**Contact Person:**

Andrew Dahlgren  
215 1st Ave. So.  
Long Prairie, MN 56347  
Phone: 320-732-4420  
Fax: 320-732-4803

**Project Title: Blue Earth CSAH 26, CSAH 12 to City of Madison Lake; Safety Improvements and Roadway Rehabilitation**

**Description:** The project consists of safety improvements and road rehabilitation on CSAH 26 for approximately 6 miles of rural, two-lane paved highway from CSAH 12 to Madison Lake just northeast of Mankato in Blue Earth County, Minnesota.

**RGU:** Blue Earth County

**Contact Person:**

Alan Forsberg, PE  
Public Works Director  
Blue Earth County Public Works  
35 Map Drive  
Mankato, MN 56001  
Phone: 507-304-4025  
Fax: 507-304-4049  
[alan.forsberg@co.blue-earth.mn.us](mailto:alan.forsberg@co.blue-earth.mn.us)

**Project Title: Wilton Gravel Site**

**Description:** Northstar Materials, Inc. proposes to expand its existing gravel mining operation, both horizontally and vertically, on 76 acres in the City of Wilton, Beltrami County, MN. The proposed gravel mining operation will be temporary and seasonal. Gravel mining operations would begin in March 2007. The operating life of the project would be approximately 16 years, depending on market demand.

The MDNR will accept written comments on the Environmental Assessment Worksheet (EAW) during the public review and comment period, which concludes Wednesday, December 6, 2006 at 4:30 p.m.

Written comments should be submitted to Matthew Langan, EAW Project Manager, Environmental Policy and Review Unit, Division of Ecological Services, Department of Natural Resources, 500 Lafayette Road, St. Paul, Minnesota, 55155-4025. Electronic or e-mail comments may be sent to [environmental.review@dnr.state.mn.us](mailto:environmental.review@dnr.state.mn.us) with “Wilton Gravel Site” in the subject line. If submitting comments electronically, please include your name and mailing address.

Public review copies of the EAW are available at the following locations:

- MDNR Library, 500 Lafayette Road, St. Paul, Minnesota, 55155;
- MDNR Regional Headquarters, 2115 Birchmont Beach Road NE, Bemidji, MN 56601;
- Minneapolis Public Library, Technology and Science Department, 300 Nicollet Mall, Minneapolis, Minnesota, 55401;
- Legislative Reference Library, 645 State Office Building, 100 Rev. Dr. Martin Luther King, Jr. Blvd., St. Paul, Minnesota, 55155;
- Bemidji Public Library, 509 American Avenue NW, Bemidji, Minnesota, 56601;

**RGU:** Minnesota Department of Natural Resources

**Contact:**

The EAW is also posted on the MDNR’s website at [www.dnr.state.mn.us](http://www.dnr.state.mn.us). (Click on “Public Input”, then select “Wilton Gravel Site” from the scroll-down list under “Environmental Review”). Additional copies may be requested by calling (651) 259-5115.

**Project Title: Chanhassen High School**

**Description:** An Environmental Assessment Worksheet (EAW) has been prepared by the City of Chanhassen to assess the potential environment impacts related to the proposed development of a public high school within the City of Chanhassen. A 95-acre site located north of Lyman Boulevard (CSAH 18), south of the Twin Cities and Western Railroad and west of Bluff Creek in Chanhassen, Minnesota, is proposed for development of a 400,000 square-foot high school building and campus to be open in the fall of 2009. The EAW describes the plan for the high school campus.

Copies of the EAW are available for public review at the following locations:

On the web: <http://www.ci.chanhassen.mn.us/serv/plan/06-35.html>

City of Chanhassen Community Development Department  
7700 Market Boulevard  
Chanhassen, MN 55317

Carver County Library - Chanhassen Branch  
7711 Kerber Boulevard  
Chanhassen, MN 55317

The public will be given an opportunity to comment on the EAW for the proposed project at a public meeting to be held November 21, 2006 at Chanhassen City Hall. Public comments on the proposed project will be accepted by the City through December 11, 2006.

**RGU: City of Chanhassen**

**Contact Person:**

Robert Generous, AICP  
City of Chanhassen  
7700 Market Boulevard  
P.O. Box 147  
Chanhassen, MN 55317-0147  
e-mail: [bgenerous@ci.chanhassen.mn.us](mailto:bgenerous@ci.chanhassen.mn.us)  
phone: (952) 227-1131  
fax: (952) 227-1110

## FINAL EIS AVAILABLE

**Project Title: Olmsted Waste-to-Energy Facility: MWC Unit 3 Project Final Environmental Impact Statement**

**Description:** Notice is hereby given that the Final Environmental Impact Statement (EIS) on the Olmsted Waste-to-Energy Facility: MWC Unit 3 Project (Project), for which the Minnesota Pollution Control Agency (MPCA) is the Responsible Government Unit (RGU), is available for public review. Pursuant to Minn. R. 4410.2800, subp. 2, publication of this notice begins a ten-day public review period during which any person may submit comments on the adequacy of the Final EIS to MPCA. This comment period will expire at 4:30 pm on November 21, 2006. In addition, a press release is being made available to media in the area of the Project pursuant to Minn. R. 4410.2700, subps. 4-6. A copy of the Final EIS will be posted on the Minnesota Pollution Control Agency Web site, at the following: <http://www.pca.state.mn.us/news/eaw/index.html>. Requests for copies of the Final EIS may be obtained by contacting Denise Leezer, Project Manager, MPCA Environmental Review and Operations Section, at (651) 297-8236. MPCA staff plans to present the Final EIS, comments received during the additional ten-day public review period and responses to those comments at a special meeting of the MPCA Citizens' Board (Board) for a determination of adequacy on or about November 28, 2006. Any person may appear at this meeting and address the Board on the subject of the adequacy of the Final EIS.

All parties on the mailing list for this Project and any other interested parties who so request will be notified of the exact date, time, and location of this public meeting, and will also receive the Board memorandum and proposed Findings of Fact, Conclusions of Law, and Order that will be presented to the Board at that meeting for its approval and adoption.

**RGU: Minnesota Pollution Control Agency**

**CONTACT PERSON:**

Denise Leezer, Project Manager  
Environmental Review and Operations Section  
Regional Division  
Minnesota Pollution Control Agency

520 Lafayette Road North  
St. Paul, Minnesota 55155-4194  
(651) 297-8236

## **EAW NEED DECISION**

The noted responsible governmental unit has made a decision regarding the need for an EAW in response to a citizen petition.

- Minnesota Pollution Control Agency, Excel Dairy, Excel Township, denied

## **EIS NEED DECISIONS**

The responsible governmental unit has determined the following projects do not require preparation of an EIS. The dates given are, respectively, the date of the determination and the date the EAW notice was published in the *EQB Monitor*.

- City of Minneapolis, 602 First Street North Renovation, October 6, 2006 (July 31, 2006)
- City of Oronoco, Cedar Woodlands II, October 3, 2006 (August 28, 2006)
- Minnesota Pollution Control Agency, Otter Tail Ag Enterprises, LLC, October 18, 2006 (September 11, 2006)
- Minnesota Pollution Control Agency, Pre-finishing Specialists, Inc., October 24, 2006 (July 3, 2006)
- Minnesota Department of Transportation, Reconstruction of Trunk Highway 65 and the Replacement of the Silverdale Bridge over the Little Fork River, Koochiching County, MN, October 23, 2006 (July 31, 2006)
- Sherburne County, County Road 81 and 200th St. (CSAH 17), October 10, 2006 (August 14, 2006)
- City of Ham Lake, Emily's Waters, October 16, 2006 (April 10, 2006)

## **PETITIONS FILED**

The following petitions have been filed with the EQB requesting preparation of an EAW. The EQB has assigned the indicated unit of government to review the petition and decide on the need for an EAW.

- Polk County, Patrick Paquin campground
- Becker County, Aaxis Development Plat on Wheeler Lake

## NOTICES

### Minnesota Forest Resources Council

#### Public Meeting Notices

- The Minnesota Forest Resources Site-level Committee will meet on Tuesday, November 14, 2006, from 9:30 a.m. – 3:00 p.m. The meeting will be held in conference room #3 at the MN Interagency Fire Center located at 402 SE 11th St. in Grand Rapids. To get additional details about the meeting, contact Mike Phillips at (651) 259-5281.
- The Minnesota Forest Resources Council (MFRC) will meet on Wednesday, November 29, 2006, from 9:30 a.m. – 3:30 p.m. at the Cloquet Forestry Center located in Cloquet. For more information, please contact Leslie McInenly at (651) 603-6761 or go to the calendar on the MFRC Website at <http://www.frc.state.mn.us>.
- The Minnesota Forest Resources Council Biomass Guideline Committee will meet on Thursday, November 16, 2006, from 9:30 a.m. – 4:30 p.m. The meeting will be held at the University of Minnesota's Cloquet Forestry Center located at 175 University Road in Cloquet. To get additional details about the meeting, contact Dick Rossman at (218) 755-4062.

**Minnesota Department of Commerce  
Notice of Public Information Meeting  
November 21, 2006, 7:30 p.m.  
Lake Wilson American Legion Hall  
On  
Site Permit Application and Draft Site Permit  
For the  
Ridgewind Power Plant  
In  
Pipestone and Murray Counties  
MPUC Docket No. IP 6603/WS-06-1327**

**PLEASE TAKE NOTICE** that a public information meeting will be held on the application by Ridgewind Power Partners, LLC, to build up to a 27-megawatt (MW) large wind energy conversion system (LWECS). The public meeting will take place at 7:30 p.m., on Tuesday, November 21, 2006, at the Lake Wilson American Legion Hall, 133 Broadway Avenue, Lake Wilson, Minnesota.

Staff of the Department of Commerce (DOC) will conduct the meeting and provide an overview of the state's wind energy site permitting process and the proposed draft site permit for the Ridgewind Power Plant. Please note that the authority for wind permits was transferred to the Minnesota Public Utilities Commission from the

Minnesota Environmental Quality Board on July 1, 2005, and responsibility for conducting the public review process was assigned to the DOC. Representatives of the applicant (Ridgewind Power Partners, LLC) will be at the meeting to describe the proposed project and answer questions.

### **Project Description**

The Ridgewind Power Plant (Project) is a Large Wind Energy Conversion System of approximately 27 MW. The turbines will be either the GE 1.5-MW or similar wind turbine mounted on freestanding tubular steel towers. The towers will be up to 100 meters (328 feet) in height. The blades on the wind turbines will be up to 45 meters (148 feet) long, resulting in a maximum overall height of 145 meters (476 feet) when one blade is in the vertical position. The rotor diameter will be up to a maximum of 90 meters (296 feet).

The electrical system will consist of 34.5 kV collection lines and facilities providing step-up transformation and 34.5 kW feeder line(s) to deliver power to the Chanarambie Substation. Other project associated facilities will include pad mounted step-up transformers and access roads.

### **Proposed Site Location**

As shown on the accompanying map, the proposed project site is located in both Pipestone and Murray counties. In Pipestone County, the turbines will be placed in the township of Burke (Section 1) and in Murray County, the turbines will be located in Cameron Township in the following sections (east half of 20, west half of 28, 29 and the west half of 33). The total wind plant project site and land easements cover approximately 2,240 acres (3.5 square miles). The total development consists of approximately 60 acres of land that will be taken out of agricultural production for turbines and access roads.

### **MPUC Site Permit Review Process**

Ridgewind Power Partners, LLC, filed a site permit application with the Public Utilities Commission for the 27-MW LWECs project on October 8, 2006, and it was considered for acceptance by the Commission on November 2, 2006. The DOC is now reviewing the Ridgewind Power Partners, LLC, site permit application under the Wind Siting Act (Minnesota Statutes, sections 116C.691 - 116C.697) and the Wind Permitting Rules (Minnesota Rules, Chapter 4401). Upon completion of the review requirements, the DOC will present the record of this matter to the PUC for a final decision.

### **Public Comments**

The site permit application, Draft Site Permit and the agency rules guiding the review process are available on the MPUC website at:

<http://energyfacilities.puc.state.mn.us/Docket.html?Id=18865>

Interested persons may comment on the site permit application and Draft Site Permit at the public meeting or may submit written or fax (651-297-1959) comments by 4:30 p.m. on **December 20, 2006**. **Please include the following docket number (IP 6603/WS-06-1327)**. Written or fax comments should be directed to: Sharon Ferguson, Department of Commerce, 85 7<sup>th</sup> Place East, Suite 500, St. Paul, MN 55101-2198.

## DOC Project Contacts

Questions about the project and the PUC permitting process may be directed to: Larry B. Hartman, Department of Commerce, 85 7<sup>th</sup> Place East, Suite 500, St. Paul, MN 55101-2198; Tel: 651-296-5089; Fax: 651-297-7891; e-mail: [larry.hartman@state.mn.us](mailto:larry.hartman@state.mn.us). Adam Sokolski, with the DOC staff, has been appointed as the public advisor to assist and advise citizens on how to participate in the site permit process. He can be contacted at: Tel: 651-296-2096; (800-657-3794); or e-mail: [adam.sokolski@state.mn.us](mailto:adam.sokolski@state.mn.us) and the mailing address above.

Questions about the Ridgewind Power Partners, LLC, Site Permit Application can also be directed to the applicant by contacting Paul White at 612-331-1486 or [paul@projectresources.net](mailto:paul@projectresources.net)

## Hearing Request

Any person may request a contested case hearing in this matter. All contested case hearing requests must be filed with Sharon Ferguson (address above) in writing by 4:30 p.m. on **Wednesday, December 20, 2006**. The person requesting the public hearing must list the issues to be addressed in the hearing and the reasons why a hearing is required to resolve those issues. The PUC shall order a contested case hearing if it finds that a material issue of fact has been raised and that the holding of the hearing will aid the PUC in making a final decision on the site permit application and draft site permit.

## Project Background Information

Copies of the Ridgewind Power Plant site permit application and proposed draft site permit have been distributed to affected landowners, and township, county and state officials. Copies of the application and Draft Site Permit are available for review at the Auditor's Offices in Pipestone and Murray counties, and the city offices in Lake Wilson and Woodstock. All project documents are available on the PUC Web site at:

<http://energyfacilities.puc.state.mn.us/Docket.html?Id=18865>

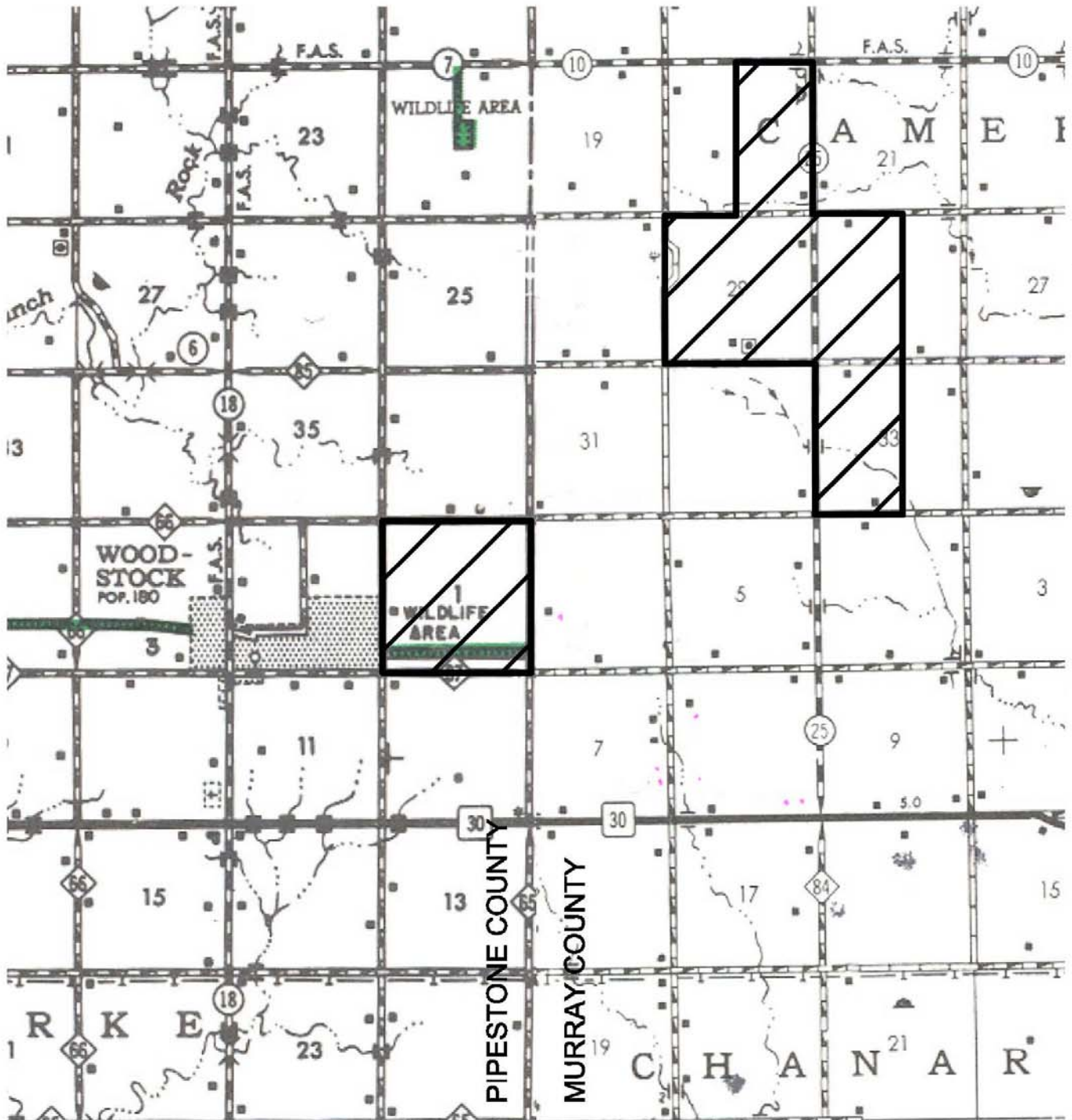

RIDGEWIND WIND POWER PLANT